

HomeSpot® JY100-NRX Wireless Neckband Replaceable Earplug Headphones



Product support page URL:

<https://homespotdigital.com/support>

Package Contents

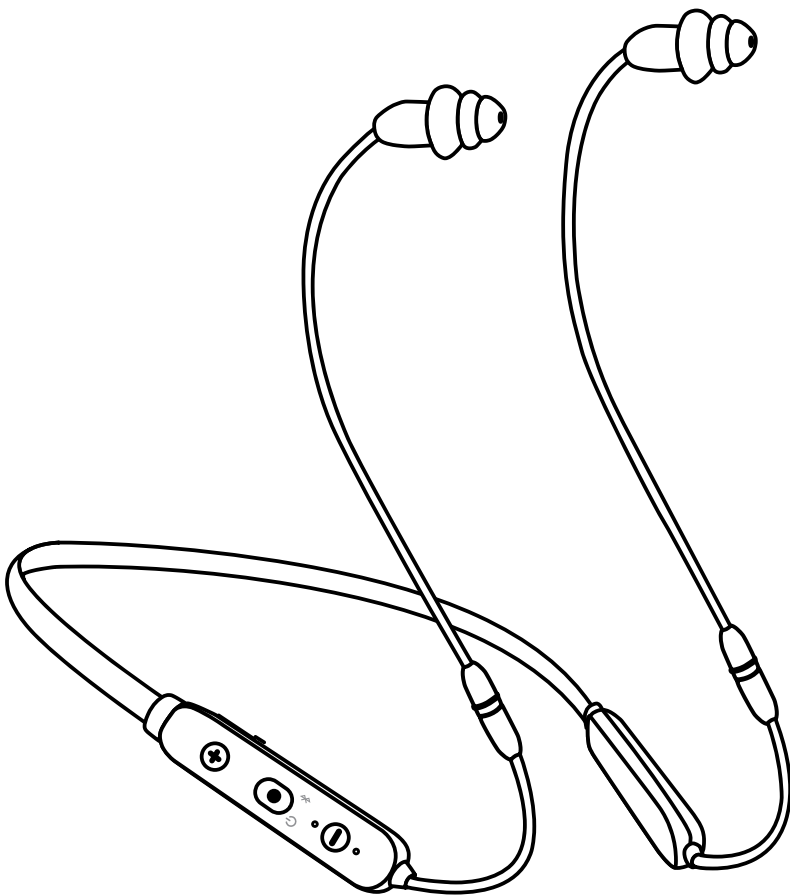

HomeSpot JY100-NRX
Wireless Neckband Replaceable
Earplug Headphones



USB-C Charging Cable

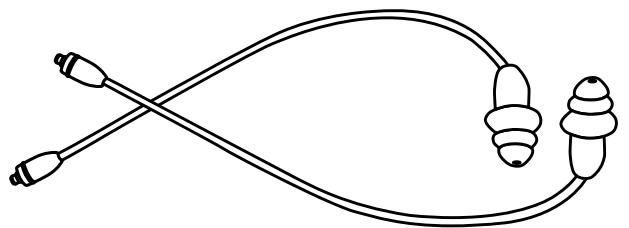

Replaceable Earplug

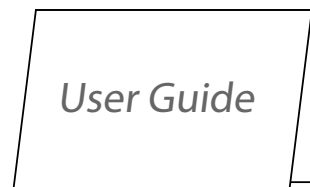

User Guide

Product Overview

L (Left)

R (Right)

MMCX
Connectors

Volume Up

USB-C

Multi-Function
Button (MFB)

LED Indicator

Volume Down

Microphone

p.2

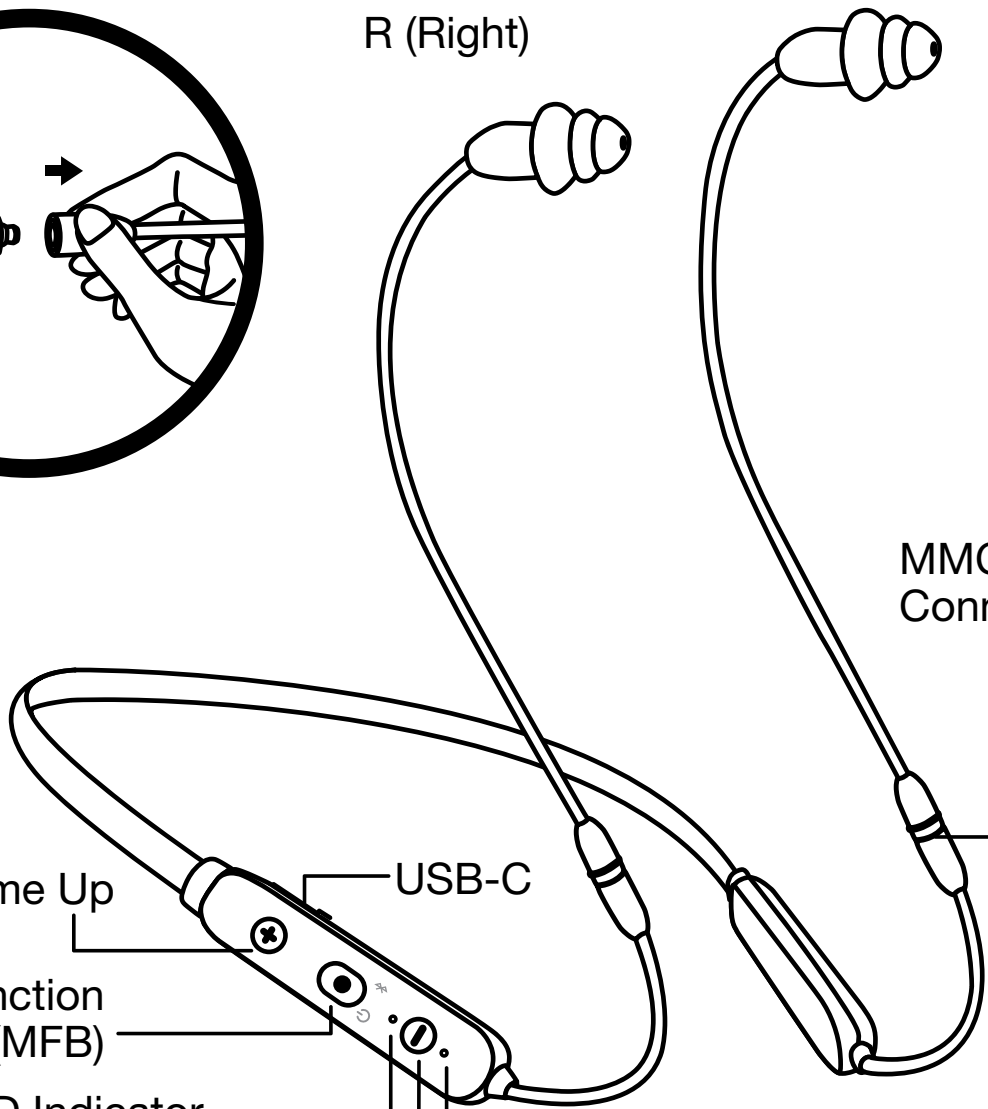
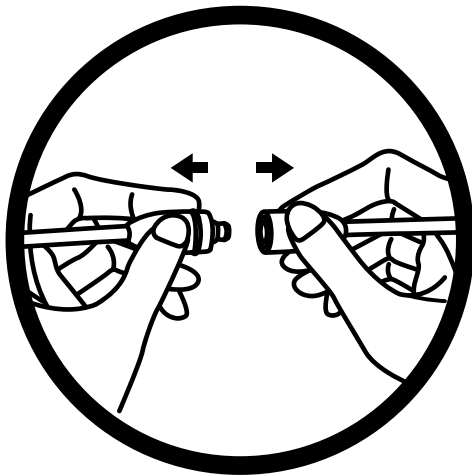

Charging & Battery Status

We recommend charging the HomeSpot JY100-NRX with a 5V 500mA or 5V 1A USB power source. Power adapters or chargers that supply more than 5.5V may damage the JY100-NRX and should not be used.

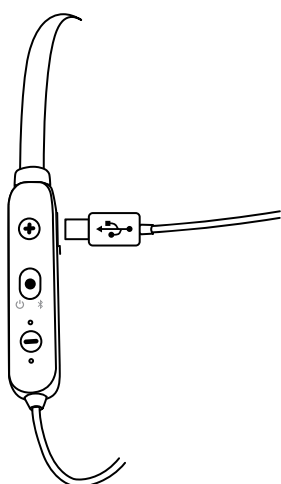

Step 1

Using the USB-C cable, connect the JY100-NRX to a USB power source.

Step 2

LED indicator will be red when charging, and will be green when the JY100-NRX is fully charged.

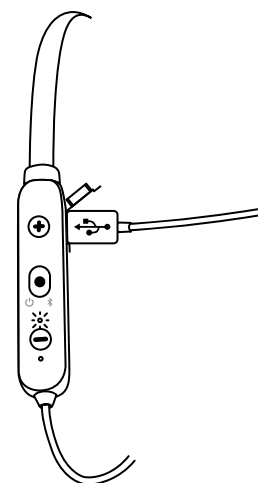

It takes up to 1-2 hours to fully charge a JY100-NRX and it can provide about 20 hours of listening time.

20 minutes of charging gives about 8 hours of listening time.

To check the JY100-NRX battery level, press the Volume +/- key when the JY100-NRX is idle (not on a call or music playing).

When battery level is below 10%, there will be a periodic warning tone and the LED indicator will flash in red.

Pairing

1. With the JY100-NRX turned off, press and hold the MFB key until you hear the “Pairing” voice prompt and the LED indicator starts flashing red and blue.
2. Turn on the Bluetooth function on your mobile device, search for and pair with “HomeSpot JY100-NRX”.
3. Once paired, you will hear the “Connected” voice prompt and the LED indicator will be blue.
4. Next time when turning on the JY100-NRX, it will try to re-connect to the previously paired device.

Controls

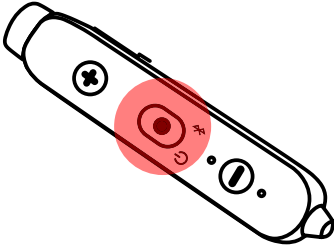
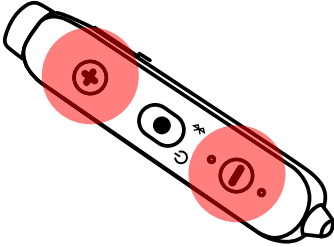
	Power on	Press and hold the MFB key for 1 second
	Power off	Press and hold the MFB key for 4 seconds
	Play/pause music	Press the MFB key during music playing
	Answer/end call	Press the MFB key during call
	Reject call	Double press the MFB key
	Activate voice assistance (Siri, OK Google)	Press and hold the MFB key for 1 second when not on a call
	Set JY100-NRX to pairing mode	Turn off JY100-NRX, then press and hold the MFB key for 7 seconds
	Reconnect to last device	Press the MFB key when the JY100-NRX is not connected to any device
Reset JY100-NRX	Turn off JY100-NRX, then press and hold the MFB key for 15 seconds, JY100-NRX will go into pairing mode after reset	
	Adjust volume	Press the Volume +/- key during call or music playing
	Next/Previous song	Press and hold the Volume +/- key for 1 second during music playing
	Check battery level	Press the Volume +/- key when the JY100-NRX is idle (not on a call or music playing)
	Mute microphone	Press and hold the Volume - key for 1 second during call Note: There will be a periodic reminder tone when microphone is muted
	Un-mute microphone	When microphone is muted, press the Volume +/- key to un-mute

Specifications

Bluetooth Version	5.4
Codec	SBC, aptX Adaptive LL/HD, AAC
Profile	A2DP, AVRCP, HFP
Effective Range	20 meters (60 feet)
Input Power	5V 500mA
Charging Time	1-2 Hours
Play Time	20 Hours

Troubleshooting

Problems	Suggestions
<ul style="list-style-type: none">□ The JY100-NRX does not turn on	<ul style="list-style-type: none">□ The battery level is too low, charge the JY100-NRX
<ul style="list-style-type: none">□ Cannot pair the JY100-NRX with my mobile device	<ul style="list-style-type: none">□ Make sure the JY100-NRX is not already connected to another device□ Make sure the JY100-NRX is in pairing mode, LED indicator should be flashing red and blue□ If the mobile device has previously paired with the JY100-NRX, remove the JY100-NRX pairing record, then re-do the pairing procedure□ Turn off the JY100-NRX, then re-do the pairing procedure□ Reset the JY100-NRX
<ul style="list-style-type: none">□ Poor audio quality	<ul style="list-style-type: none">□ Reduce the distance and remove obstacles between the JY100-NRX and the paired mobile device

WARNING: Due to the isolating characteristics of these headphones do not use while driving, riding a bike or where vehicular traffic is present, or in any other activity where failure to hear surrounding sounds could be dangerous. Use of these headphones at excessive volumes may cause permanent hearing damage. Always turn the volume down before use. Take caution in regards to inserting objects into ear canal, use at own risk.

COMPLIANCE

This device complies with Industry Canada licence-exempt RSS standard(s).

Operation is subject to the following two conditions: (1) This device may not cause interference, and (2) This device must accept any interference, including interference that may cause undesired operation of the device.

Le présent appareil est conforme aux CNR d'Industrie Canada applicables aux appareils radio exempts de licence. L'exploitation est autorisée aux deux conditions suivantes:

- (1) l'appareil ne doit pas produire de brouillage, et
- (2) l'utilisateur de l'appareil doit accepter tout brouillage radioélectrique subi, même si le brouillage est susceptible d'en compromettre le fonctionnement.

This device complies with Part 15 of the FCC Rules. Operation is subject to the following two conditions:

- (1) this device may not cause harmful interference, and
- (2) this device must accept any interference received, including interference that may cause undesired operation.

NOTE:

This equipment has been tested and found to comply with the limits for a Class B digital device, pursuant to Part 15 of the FCC Rules. These limits are designed to provide reasonable protection against harmful interference in a residential installation. This equipment generates, uses, and can radiate radio frequency energy and, if not installed and used in accordance with the instructions, may cause harmful interference to radio communications.

However, there is no guarantee that interference will not occur in a particular installation. If this equipment does cause harmful interference to radio or television reception, which can be determined by turning the equipment off and on, the user is encouraged to try to correct the interference by one or more of the following measures:

- Reorient or relocate the receiving antenna.
- Increase the separation between the equipment and receiver.
- Connect the equipment into an outlet on a circuit different from that to which the receiver is connected.
- Consult the dealer or an experienced radio/TV technician for help.

This equipment must not be co-located or operated in conjunction with any other antenna or transmitter.

FCC ID: B4O-HSBTHJY, IC: 21698-HSBTHJY

TRADEMARK

- Siri is a trademark of Apple Inc., registered in the U.S. and other countries.
- OK Google is a trademark of Google LLC.
- The Bluetooth® word mark and logos are owned by Bluetooth SIG, Inc. and any use of such marks by HomeSpot® is under license.
- Qualcomm aptX is a product of Qualcomm Technologies, Inc. and/or its subsidiaries.
- Qualcomm is a trademark of Qualcomm Incorporated, registered in the United States and other countries. aptX is a trademark of Qualcomm Technologies International, Ltd., registered in the United States and other countries.